

US 20/OR 34 at Highway 99W

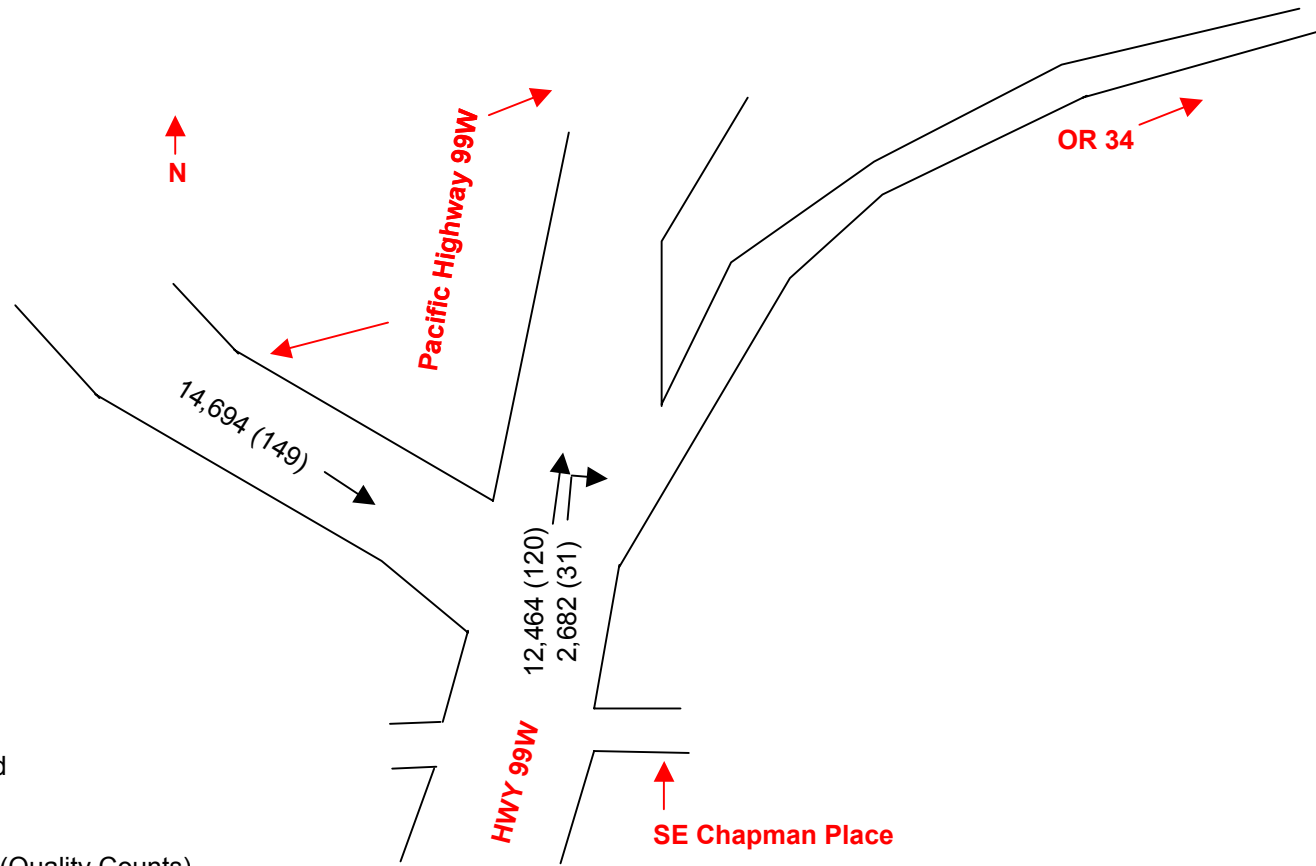

*Pedestrians not counted

Source: May 25th, 2005 (Quality Counts)

Vehicles
(Bikes)

US 20/OR 34 at Highway 99W

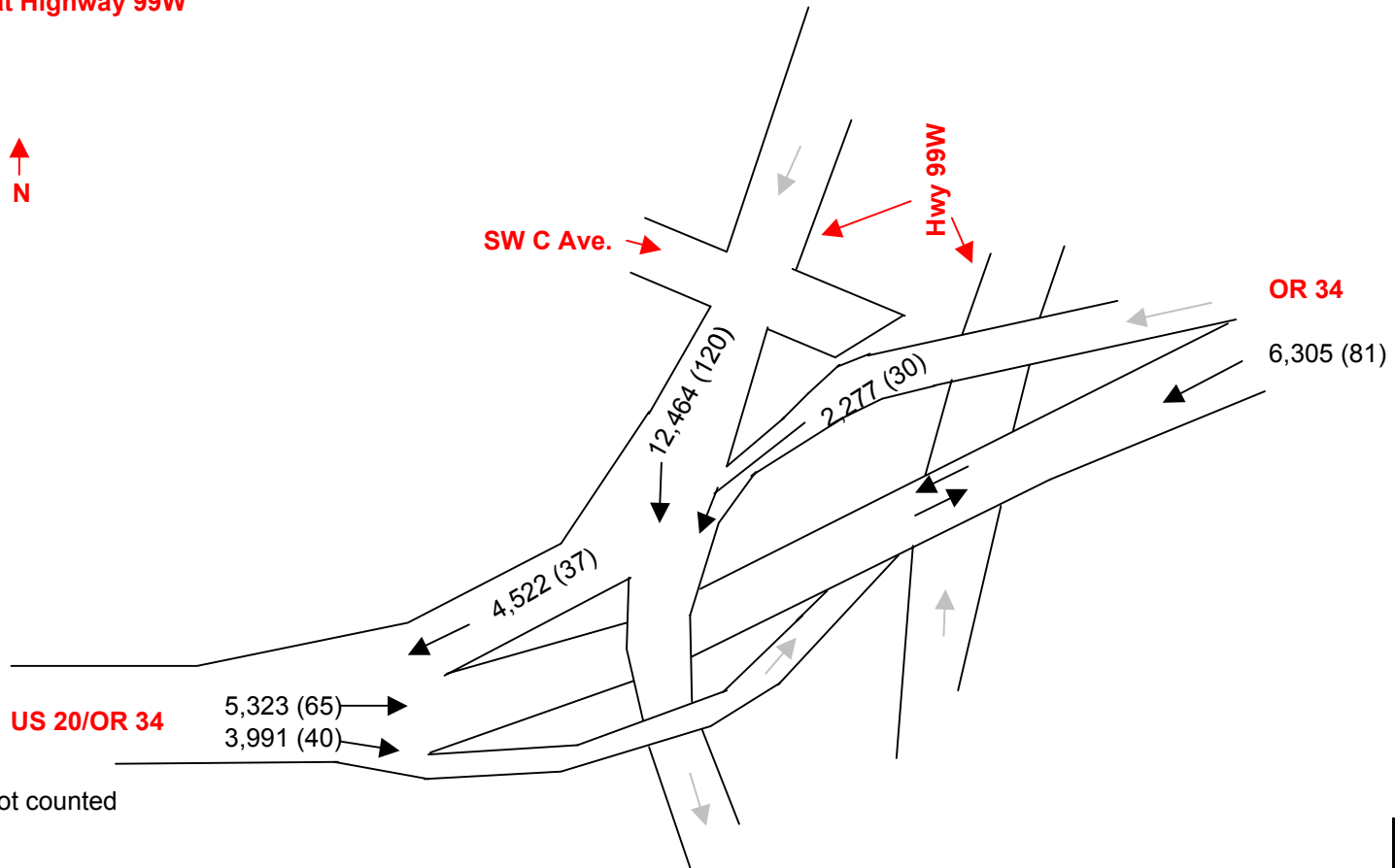

*Pedestrians not counted

Source: May 25th, 2005 (Quality Counts)

Vehicles
(Bikes)

US 20/OR 34 at Highway 99W

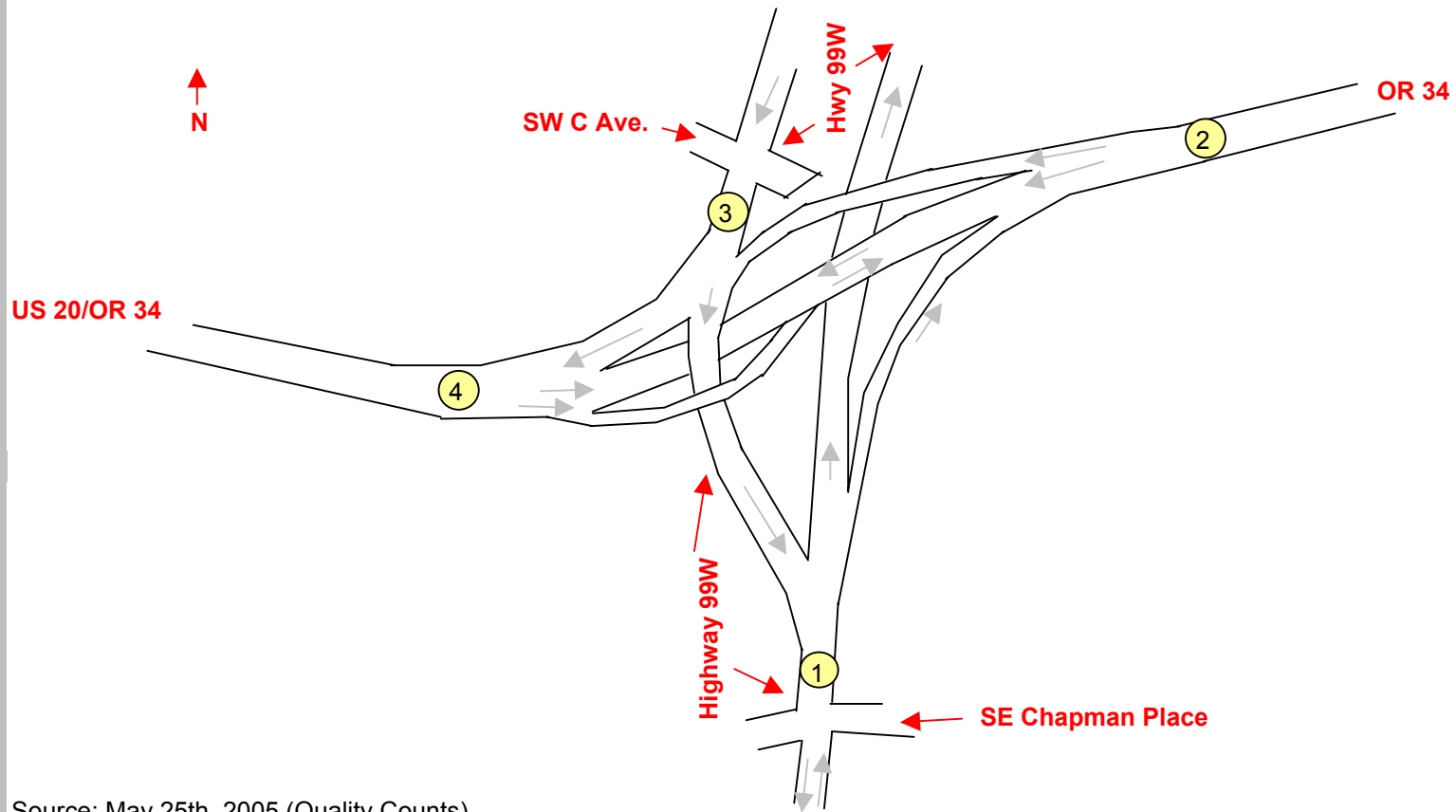

Source: May 25th, 2005 (Quality Counts)